

Miramar Park of Commerce

3991 Commerce Parkway
Miramar, FL 33025

Sublease in Well Established Industrial Park



Contact Us

Tom O'Loughlin
Executive Vice President
+1 954 817 3919
tom.oloughlin@cbre.com

Michael Oretsky
Senior Associate
+1 954 798 4284
michael.oretsky@cbre.com

Floor Plan

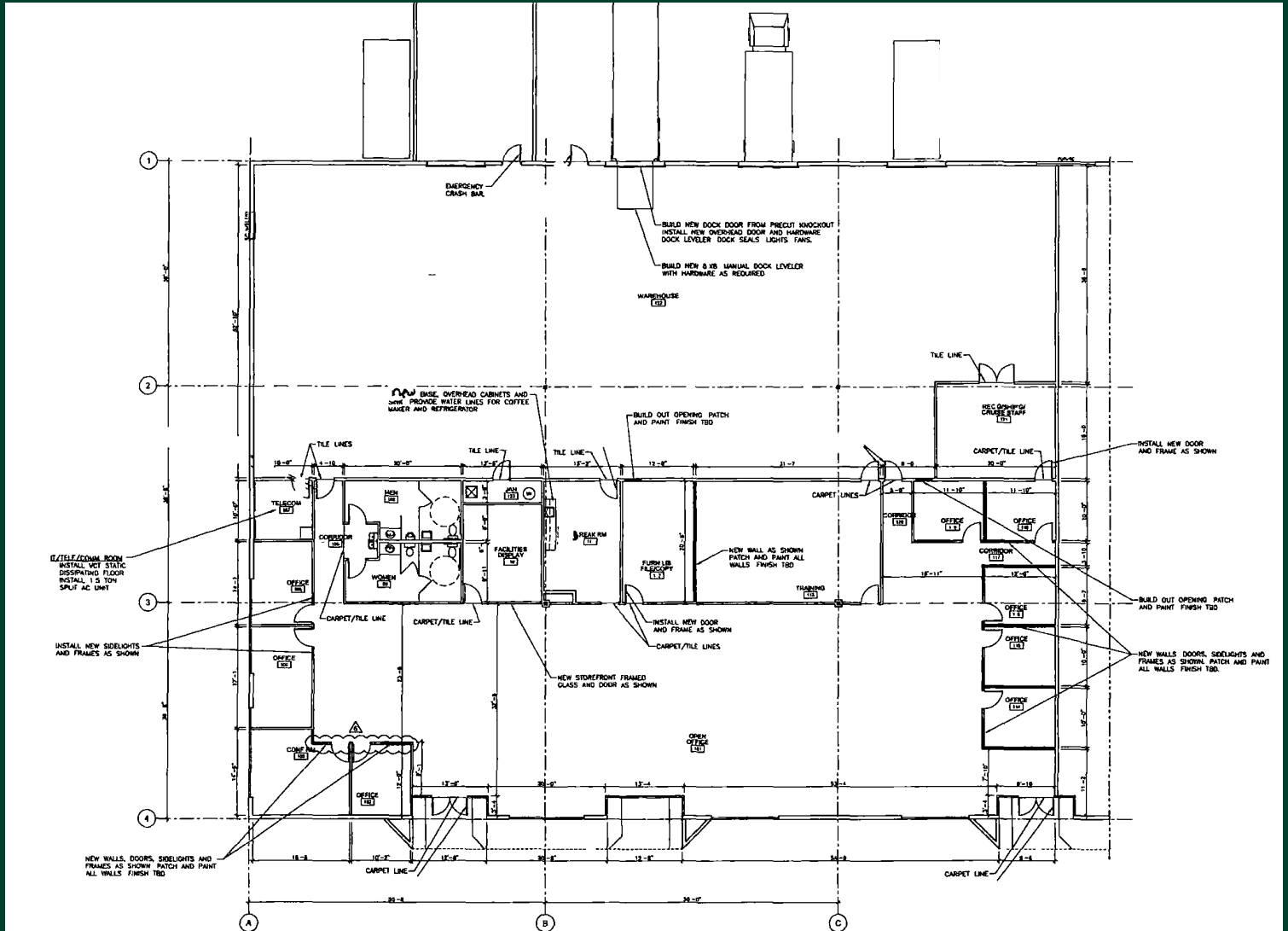

Property Details

- + ±14,997 SF available
- + ±8,057 SF office area
- + ±6,940 SF warehouse
- + Built 1992
- + 20' - 24' clear height
- + 4 dock high doors
- + 2/29/2024 expiration of current lease
- + 1.5/1,000 SF Parking
- + Located in preferred, widely recognized industrial submarket
- + Central location within the Tri-County region allows for efficient distribution patterns
- + 80% of South Florida's 6.2 million population live within 60 minute drive
- + Excellent surrounding amenity base
- + **Asking Rate: \$12.00 PSF NNN plus \$4.88 OpEx**

© 2022 CBRE, Inc. All rights reserved. This information has been obtained from sources believed reliable, but has not been verified for accuracy or completeness. You should conduct a careful, independent investigation of the property and verify all information. Any reliance on this information is solely at your own risk. CBRE and the CBRE logo are service marks of CBRE, Inc. All other marks displayed on this document are the property of their respective owners, and the use of such logos does not imply any affiliation with or endorsement of CBRE. Photos herein are the property of their respective owners. Use of these images without the express written consent of the owner is prohibited.